

TECHNICAL MANUAL

**ORGANIZATIONAL, DIRECT SUPPORT AND
GENERAL SUPPORT MAINTENANCE
REPAIR PARTS AND SPECIAL TOOLS LIST
(INCLUDING DEPOT MAINTENANCE
REPAIR PARTS AND SPECIAL TOOLS)**

**AIR CONDITIONER, FLOOR MOUNTED,
AIR COOLED
ELECTRIC MOTOR DRIVEN, 3/4 HP 60 CYCLE
SINGLE PHASE, 9,000 BTU/HR
HARVEY W. HOTTEL, INC.
MODEL HAC-750H**

HEADQUARTERS, DEPARTMENT OF THE ARMY

28 SEPTEMBER 1979

TM 5-4120-351-24P
C4

CHANGE
NO. 4

HEADQUARTERS
DEPARTMENT OF THE ARMY
WASHINGTON, D.C., 31 October 1996

ORGANIZATIONAL, DIRECT SUPPORT AND GENERAL SUPPORT
MAINTENANCE REPAIR PARTS AND SPECIAL TOOLS LIST
(INCLUDING DEPOT MAINTENANCE REPAIR
PARTS AND SPECIAL TOOLS)

**AIR CONDITIONER, FLOOR MOUNTED, AIR COOLED
ELECTRIC MOTOR DRIVEN, 3/4 HP 60 CYCLE
SINGLE PHASE, 9,000 BTU/HR
(HARVEY W. HOTTEL, INC., MODEL HAC-750H)
NSN 4120-00-592-4645**

DISTRIBUTION STATEMENT A: Approved for public release; distribution is unlimited.

TM 5-4120-351-24P, 28 September 1979, is changed as follows:

1. Remove and insert pages as indicated below. New or changed text material is indicated by a vertical bar in the margin. An illustration change is indicated by a miniature pointing hand.

Remove pages	Insert pages
i/(ii blank) 13 and 14	i/(ii blank) 13 and 14

2. Retain this sheet in front of manual for reference purposes.

By Order of the Secretary of the Army:

Official

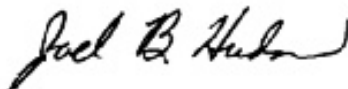

JOEL B. HUDSON
*Administrative Assistant to the
Secretary of the Army*
02916

DENNIS J. REIMER
*General, United States Army
Chief of Staff*

DISTRIBUTION:

To be distributed in accordance with DA Form 12-25-E, block no. 0047, requirements for TM 5-4120-351-24P.

CHANGE
NO. 3

HEADQUARTERS
DEPARTMENT OF THE ARMY
WASHINGTON, D. C., 4 April 1994

Organizational, Direct Support and General Support
Maintenance Repair Parts and Special Tools List
(Including Depot Maintenance Repair
Parts and Special Tools)

**AIR CONDITIONER, FLOOR MOUNTED, AIR COOLED
ELECTRIC MOTOR DRIVEN, 3/4 HP 60 CYCLE
SINGLE PHASE, 9,000 BTU/HR
(HARVEY W. HOTTEL, INC., MODEL HAC-750H)
NSN 4120-00-592-4645**

DISTRIBUTION STATEMENT A: Approved for public release; distribution is unlimited.

TM 5-4120-351-24P, 28 September 1979, is changed as follows:

1. Remove and insert pages as indicated below. New or changed text material is indicated by a vertical bar in the margin. An illustration change is indicated by a miniature pointing hand.

Remove pages	Insert pages
i/(ii blank)	i/(ii blank)
13 through 16	13 through 16
25 through 27/(28 blank)	25 through 27/(28 blank)

2. Retain this sheet in front of manual for reference purposes.

By Order of the Secretary of the Army:

Official:

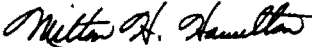
MILTON H. HAMILTON
Administrative Assistant to the
Secretary of the Army

GORDON R. SULLIVAN
General, United States Army
Chief of Staff

DISTRIBUTION:

To be distributed in accordance with DA Form 12-25-E, block no. 0047, requirements for
TM 5-4120-351-24P.

CHANGE
NO. 2

HEADQUARTERS
DEPARTMENT OF THE ARMY
WASHINGTON, D.C., 26 FEBRUARY 1993

Organizational, Direct Support and General Support
Maintenance Repair Parts and Special Tools List
(Including Depot Maintenance Repair
Parts and Special Tools)

AIR CONDITIONER, FLOOR MOUNTED, AIR COOLED
ELECTRIC MOTOR DRIVEN, 3/4 HP 60 CYCLE
SINGLE PHASE, 9,000 BTU/HR
(HARVEY W. HOTTEL, INC. MODEL HAC-750H)
NSN 4120-00-592-4645

DISTRIBUTION STATEMENT A: Approved for public release; distribution is unlimited.

TM 5-4120-351-24P, 28 September 1979, is changed as follows:

1. Remove and insert pages as indicated below. New or changed text material is indicated by a vertical bar in the margin. An illustration change is indicated by a miniature pointing hand.

Remove pages	Insert pages
✓ 7 and 8	7 and 8
✓ - - -	✓ 8.1 and 8.2
✓ 9 and 10	9 and 10
✓ 15 and 16	15 and 16
✓ - - -	16.1 and 16.2
✓ 19 and 20	19 and 20
✓ 25 through 27/(28 blank)	25 through 27/(28 blank)

2. Retain this sheet in front of manual for reference purposes.

By Order of the Secretary of the Army:

GORDON R. SULLIVAN
General, United States Army
Chief of Staff

Official:

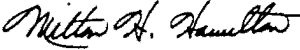
MILTON H. HAMILTON
Administrative Assistant to the
Secretary of the Army

03815

DISTRIBUTION:

To be distributed in accordance with DA Form 12-25-E, block no. 0047, requirements for TM 5-4120-351-24P.

CHANGE }
No. 1 }

HEADQUARTERS
DEPARTMENT OF THE ARMY
WASHINGTON, D.C., 4 May 1987

Organizational, Direct Support and General Support
Maintenance Repair Parts and Special Tools List
(Including Depot Maintenance Repair
Parts and Special Tools)

AIR CONDITIONER, FLOOR MOUNTED, AIR COOLED
ELECTRIC MOTOR DRIVEN, 3/4/HP 60 CYCLE
SINGLE PHASE, 9,000 BTU/HR
(HARVEY W. HOTTEL, INC. MODEL HAC-750H)
NSN 4120-00-592-4645

TM 5-4120-351-24P, 28 September 1979, is changed as follows:

1. Remove and insert pages as indicated below. New or changed text material is indicated by a vertical bar in the margin. An illustration change is indicated by a miniature pointing hand.

Remove pages

~~i/ii~~
~~15 and 16~~
~~25 and 26~~

Insert pages

i/ii
15 and 16
25 and 26

2. Retain this sheet in front of manual for reference purposes.

By Order of the Secretary of the Army:

JOHN A. WICKHAM, JR.
General, United States Army
Chief of Staff

Official:

R. L. DILWORTH
Brigadier General, United States Army
The Adjutant General

DISTRIBUTION:

To be distributed in accordance with DA Form 12-25A, Organizational, Direct Support and General Support Maintenance requirements for Air Conditioner, Floor Mounted, 9,000 BTU, 3/4 HP, 60HZ, AC, 1PH (HAC-751H) (TM 5-4120-351 Series)

ORGANIZATIONAL, DIRECT SUPPORT AND GENERAL SUPPORT
 MAINTENANCE REPAIR PARTS AND SPECIAL TOOLS LIST
 (INCLUDING DEPOT MAINTENANCE REPAIR
 PARTS AND SPECIAL TOOLS)

**AIR CONDITIONER, FLOOR MOUNTED, AIR COOLED
 ELECTRIC MOTOR DRIVEN, 3/4/HP 60 CYCLE
 SINGLE PHASE, 9,000 BTU/HR
 (HARVEY W. HOTTEL, INC. MODEL HAC-750H)
 NSN 4120-00-592-4645**

Current as of 23 October 1986

REPORTING ERRORS AND RECOMMENDING IMPROVEMENTS

You can help improve this manual. If you find any mistakes, or if you know of a way to improve these procedures, please let us know. Mail your letter or DA Form 2028 (Recommended Changes to Publications and Blank Forms), or DA Form 2028-2 located in the back of this manual directly to: Commander, US Army Aviation and Troop Command, ATTN: AMSAT-I-MP, 4300 Goodfellow Blvd., St. Louis, MO 63120-1798. You may also submit your recommended changes by E-mail directly to <mpmt/oavma28@st-louis-emh7.army.mil>. A reply will be furnished directly to you. Instructions for sending an electronic 2028 may be found at the back of this manual immediately preceding the hard copy 2028.

DISTRIBUTION STATEMENT A: Approved for public release; distribution is unlimited.

TABLE OF CONTENTS

		Listing Page	Illus Figure
Section I.	INTRODUCTION		
Section II.	REPAIR PARTS LIST		
Group 01.	Body Chassis	7	
	Panels and Cover		1
	Grilles and Front Panel		2
Group 02.	Electric Motor and Fans	11	
	Fans		3
	Fan Motor		4
03.	Starting and Protective Devices	15	5
04.	Wiring	17	6
05.	Gas Compressor, Piping and Components	19	7
06.	Filter	23	8
07.	Actuator	25	9
Section III.	SPECIAL TOOLS LIST (Not Applicable)		
Section IV.	NATIONAL STOCK NUMBER AND REFERENCE NUMBER INDEX	26	

Section I. INTRODUCTION

1. Scope.

This manual lists spares and repair parts; special tools; special test, measurement, and diagnostic equipment (TMDE), and other special support equipment required for performance of organizational, direct support, and general support maintenance of the Air Conditioner. It authorizes the requisitioning and issue of spares and repair parts as indicated by the source and maintenance codes.

2. General.

This Repair Parts and Special Tools List is divided into the following sections:

a. Section II. Repair Parts List. A list of spares and repair parts authorized for use in the performance of maintenance. The list also includes parts which must be removed for replacement of the authorized parts. Parts lists are composed of functional groups in numeric sequence, with the parts in each group listed in figure and item number sequence. Bulk materials are listed in NSN sequence.

b. Section III. Special Tools List. A list of special tools, special TMDE, and other special support equipment authorized for the performance of maintenance.

c. Section IV. National Stock Number and Part Number Index. A list, in National item identification number (NIIN) sequence, of all National stock numbers (NSN) appearing in the listings, followed by a list in alphameric sequence of all part numbers appearing in the listings. National stock numbers and part numbers are cross-referenced to each illustration figure and item number appearance. This index is followed by a cross-reference list of reference designators to figure and item numbers.

3. Explanation of Columns.

a. Illustration. This column is divided as follows:

(1) Figure Number. Indicates the figure number of the illustration on which the item is shown.

(2) Item Number. The number used to identify item called out in the illustration.

tify item called out in the illustration.

b. Source, Maintenance, and Recoverability (SMR) Codes.

(1) Source Code. Source codes indicate the manner of acquiring support items for maintenance, repair, or overhaul of end items. Source codes are entered in the first and second positions of the Uniform SMR Code format as follows:

Code	Definition
PA	Item procured and stocked for anticipated or known usage.
PB	Item procured and stocked for insurance purpose because essentiality dictates that a minimum quantity be available in the supply system.
PC	Item procured and stocked and which otherwise would be coded PA except that it is deteriorative in nature.
PD	Support item, excluding support equipment, procured for initial issue or outfitting and stocked only for subsequent or additional initial issues or outfitting. Not subject to automatic replenishment.
PE	Support equipment procured and stocked for initial issue or outfitting to specified maintenance repair activities.
PF	Support equipment which will not be stocked but which will be centrally procured on demand.
PG	Item procured and stocked to provide for sustained support for the life of the equipment. It is applied to an item peculiar to the equipment which, because of probable discontinuance or shutdown of production facilities, would prove uneconomical to reproduce at a later time.
KD	An item of a depot overhaul/repair kit and not purchased separately. Depot kit defined as a kit that provides item required at the time of overhaul or repair.
KF	An item of a maintenance kit and not purchased separately. Maintenance kit defined as a kit that provides an item that can be replaced at organizational or intermediate levels of maintenance.

Code	Definition
KB	Item included in both a depot overhaul/repair kit and a maintenance kit.
MO	Item to be manufactured or fabricated at organizational level.
MF	Item to be manufactured or fabricated at the direct support maintenance level.
MH	Item to be manufactured or fabricated at the general support maintenance level.
MD	Item to be manufactured or fabricated at the depot maintenance level.
AO	Item to be assembled at organizational level.
AF	Item to be assembled at direct support maintenance level.
AH	Item to be assembled at general support maintenance level.
AD	Item to be assembled at depot maintenance level.
XA	Item is not procured or stocked because the requirements for the item will result in the replacement of the next higher assembly.
XB	Item is not procured or stocked. If not available through salvage, requisition.
XC	Installation drawing, diagram, instruction sheet, field service drawing, that is identified by manufacturer's part number.
XD	A support item that is not stocked. When required, item will be procured through normal supply channels.

NOTE: Cannibalization or salvage maybe used as a source of supply for any items coded above except those coded XA and aircraft support items as restricted by AR 700-42.

(2) Maintenance Code. Maintenance codes are assigned to indicate the levels of maintenance authorized to USE and REPAIR support items. The maintenance codes are entered in the third and fourth positions of the Uniform SMR Code format as follows:

(a) The maintenance code entered in the third position will indicate the lowest maintenance level authorized to remove, replace, and use the support item. The maintenance code entered in the

third position will indicate one of the following levels of maintenance:

Code	Application/Explanation
C	Crew or operator maintenance performed within organizational maintenance.
O	Support item is removed, replaced, used at the organizational level.
F	Support item is removed, replaced, used at the direct support level.
H	Support item is removed, replaced, used at the general support level.
D	Support items that are removed, replaced, used at depot, mobile depot, or specialized activity only.

(b) The maintenance code entered in the fourth position indicates whether the item is to be repaired and identifies the lowest maintenance level with the capability to perform complete repair (i.e., all authorized maintenance functions). This position will contain one of the following maintenance codes.

Code	Application/Explanation
O	The lowest maintenance level capable of complete repair of the support item is the organizational level.
F	The lowest maintenance level capable of complete repair of the support item is the direct support level.
H	The lowest maintenance level capable of complete repair of the support item is the general support level.
D	The lowest maintenance level capable of complete repair of the support item is the depot level.
L	Repair restricted to (enter applicable designated specialized repair activity), Specialized Repair Activity.
Z	Nonreparable. No repair is authorized.
B	No repair is authorized. The item may be reconditioned by adjusting, lubricating, etc., at the user level. No parts or special tools are procured for the maintenance of this item.

(3) Recoverability Code. Recoverability codes are assigned to support items to indicate the disposition action on unserviceable items. The recoverability code is entered in the fifth position of the Uniform SMR Code format as follows:

Recoverability Code	Definition
Z	Nonreparable item. When un-serviceable, condemn and dispose at the level indicated in position 3.
O	Reparable item. When un-economically reparable, condemn and dispose at organizational level.
F	Reparable item. When un-economically reparable, condemn and dispose at the direct support level.
H	Reparable item. When un-economically reparable, condemn and dispose at the general support level.
D	Reparable item. When beyond lower level repair capability, return to depot. Condemnation and disposal not authorized below depot level.
L	Reparable item. Repair, condemnation, and disposal not authorized below depot/specialized repair activity level.
A	Item requires special handling or condemnation procedures because of specific reasons (i.e., precious metal content, high dollar value, critical material or hazardous material). Refer to appropriate manuals/directives for specific instructions.

c. National Stock Number. Indicates the National stock number assigned to the item and which will be used for requisitioning.

d. Part Number. Indicates the primary number used by the manufacturer (individual, company, firm, corporation, or Government activity), which controls the design and characteristics of the item by means of its engineering drawings, specifications, standards, and inspection requirements to identify an item or range of items. **NOTE:** When a stock numbered item is requisitioned, the item received may have a different part number than the part being replaced.

e. Federal Supply Code for Manufacturer (FSCM). The FSCM is a 5-digit numeric code listed in SB 708-42 which is used to identify the manufacturer, distributor, or Government agency, etc.

f. Description. Indicate the Federal item name and, if required, a minimum description to identify the item. Items that are included in kits and sets are listed below the name of the kit or set with the quantity of each item in the kit or set indicated in the quantity incorporated in unit column. When the part to be used differs between serial numbers of the same model, the effective serial numbers are shown as the last line of the description. When density of equipments supported exceeds density spread indicated in the basis of issue the total authorization is increased accordingly.

g. Unit of Measure (U/M). Indicates the standard of the basic quantity of the listed item as used in performing the actual maintenance function. This measure is expressed by a two-character alphabetical abbreviation (e.g., ea, in, pr, etc). When the unit of measure differs from the unit of issue, the lowest unit of issue that will satisfy the required units of measure will be requisitioned.

h. Quantity Incorporated in Unit. Indicates the quantity of the item used in the breakout shown on the illustration figure, which is prepared for a functional group, subfunctional group, or an assembly. A "V" appearing in this column in lieu of a quantity indicates that no specific quantity is applicable, (e.g., shims, spacers, etc).

4. Special Information. The following publications pertain to Air Conditioner, 9,000 BTU and its components:

- TM 5-4120-351-14
- Air Conditioner, 9,000 BTU

5. How to Locate Repair Parts.

a. When National Stock Number or Part Number is Unknown:

(1) First. Using the Table of Contents determine the functional group within which the item belongs. This is necessary since illustrations are prepared for functional groups and listings are divided into the same groups.

(2) Second. Find the illustration covering the (insert as applicable-functional group or subgroup) to which the item belongs.

(3) Third. Identify the item on the illustration and note the illustration figure and item number of the item.

(4) Fourth. Using the Repair Parts Listing, find the figure and item number noted on the illustration.

b. When National Stock Number or Part Number is Known:

(1) First. Using the Index of National Stock Numbers and Part Numbers, find the pertinent National stock number or part number. This index is in NIIN sequence followed by a list of part numbers in alphameric sequence, cross-referenced to the illustration figure number and item number.

(2) Second. After finding the figure and item number, locate the figure and item number in the repair parts list.

6. Abbreviations. (Not applicable).

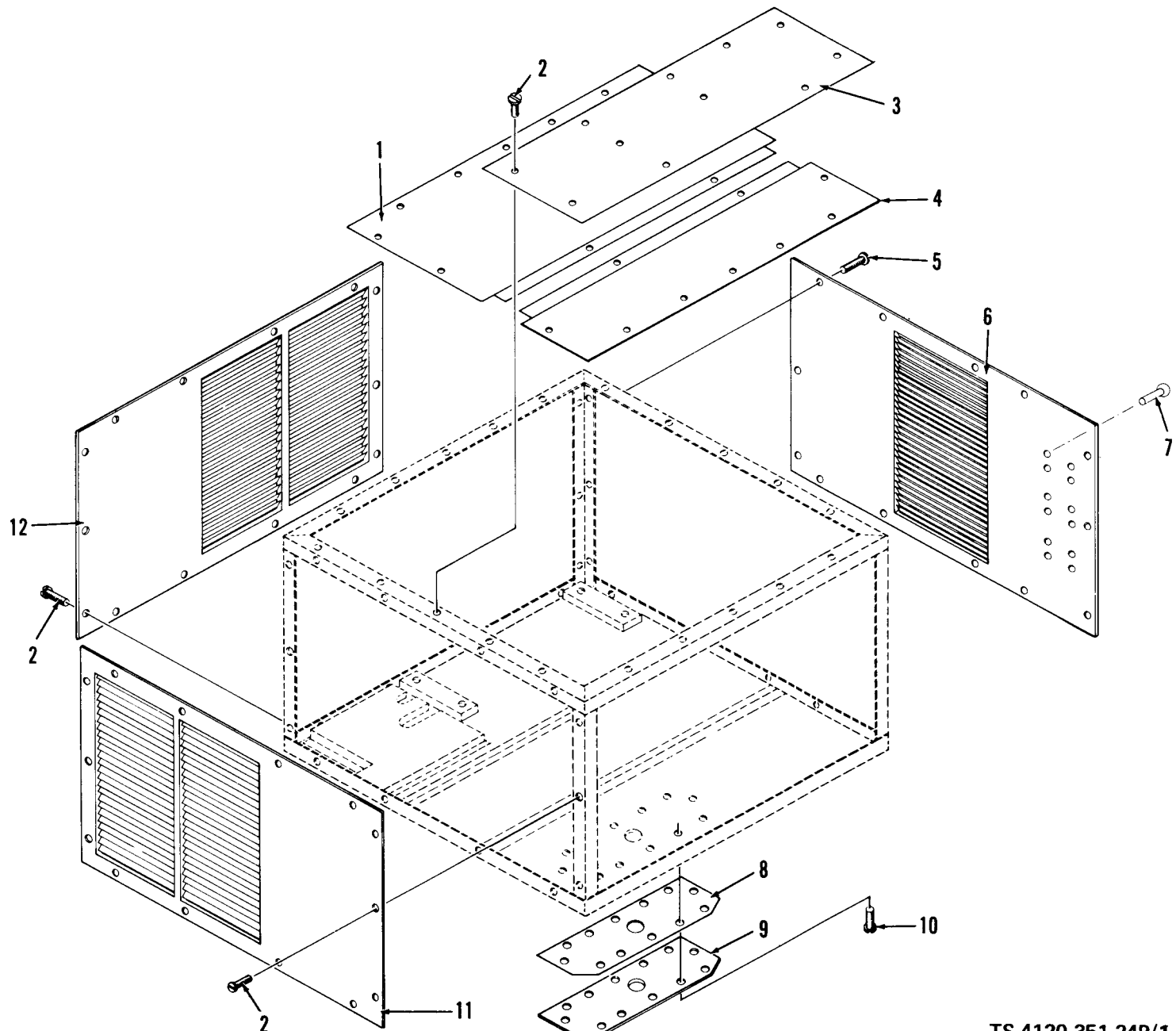

Figure 1. Panels and Covers

TS-4120-351-24P/1

(1) ILLUSTRATION (a) FIG NO.	(2) (b) ITEM NO.	SMR CODE	(3) NATIONAL STOCK NUMBER	(4) PART NUMBER	(5) FSCM	TM5-4120-351-24P (6) DESCRIPTION USABLE ON CODE	(7) U\M	(8) QTY INC IN UNIT
SECTION II-REPAIR PARTS LIST								
GROUP 01 BODY CHASSIS								
1	1	XBOZZ		13211E4532	97403	PANE, TOP, REAR	EA	1
1	2	PAOZZ	5305-00-054-6670	MS51957-45	96906	SCREW,MACHINE	EA	1
1	3	XBOZZ		13221E4531	97403	PANEL, TOP, CENTER	EA	1
1	4	XBOZZ		13221E4530	97403	PANEL, TOP, FRONT	EA	1
1	5	PAOZZ	5305-00-054-6672	MS51957-47	96906	SCREW, MACHINE	EA	1
1	6	XBOZZ		13221E4562	97403	PANEL, RIGHT SIDE	EA	1
1	7	PAOZZ	5320-00-957-2499	MS20604B4W2	96906	RIVET, BLIND	EA	12
1	8	XBOZZ		13221E4537	97403	GASKET, FILTER COVER	EA	1
1	9	XBOZZ		13221E4536	97403	COVER, FILTER	EA	1
1	10	PAOZZ	5305-00-054-6671	MS51957-46	96906	SCREW, MACHINE	EA	12
1	11	XBOZZ		13221E4563	97403	PANEL, LEFT SIDE	EA	1
1	12	PBOZZ	4120-01-188-8199	13221E4569	97403	PANEL, REAR	EA	1

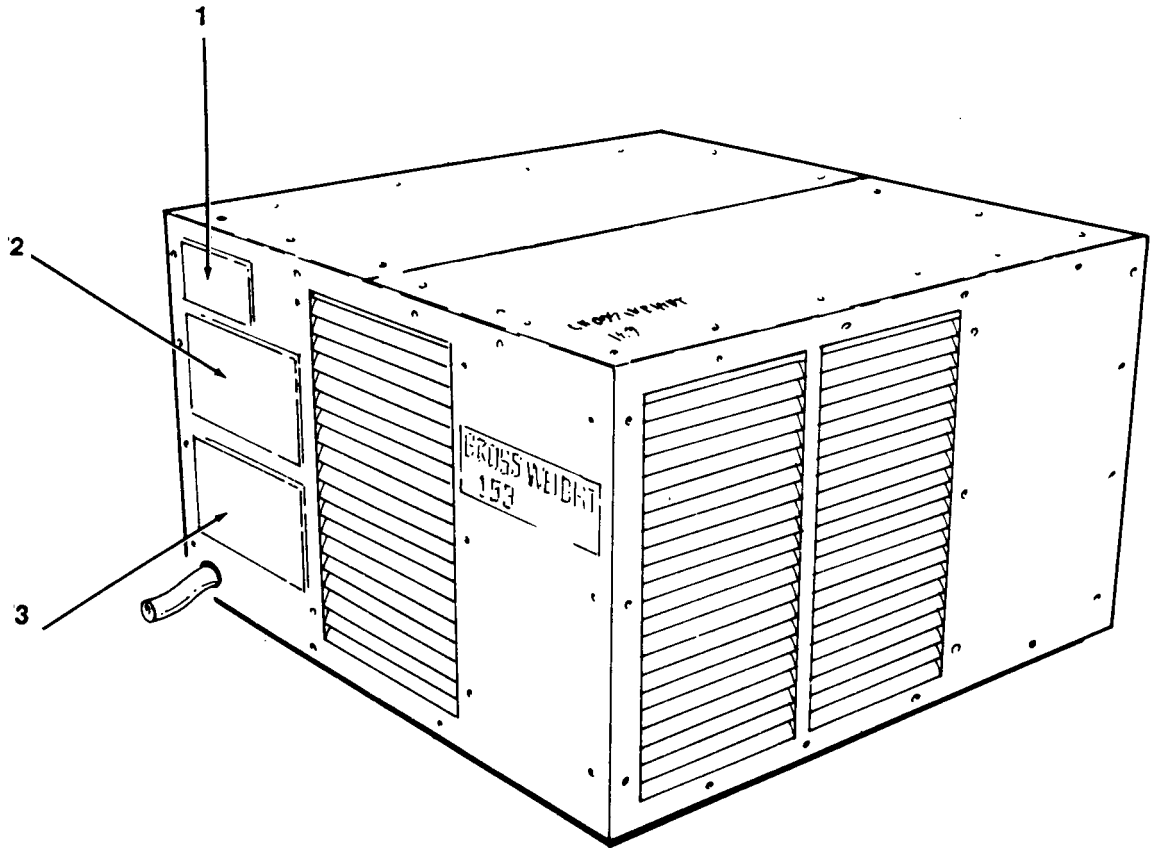

Figure 1A. Data Plates

				TM5-4120-351-24P			
(1)	(2)	(3)	(4)	(5)	(6)	(7)	(8)
ILLUSTRATION					DESCRIPTION		QTY
(a)	(b)						INC
FIG	ITEM	SMR	NATIONAL	PART			IN
NO.	NO.	CODE	STOCK	NUMBER	FSCM	USABLE ON CODE	U\M
			NUMBER				UNIT
						GROUP 01 BODY CHASSIS	
1A	1	PAOZZ		R612-77-63045	97450	PLATE, IDENTIFICATION	EA 1
1A	2	PAOZZ		13221E4552	97403	PLATE, REFRIGERATION DIAGRAM	EA 1
1A	3	PAOZZ		13221E4584	97403	PLATE, WIRING	EA 1

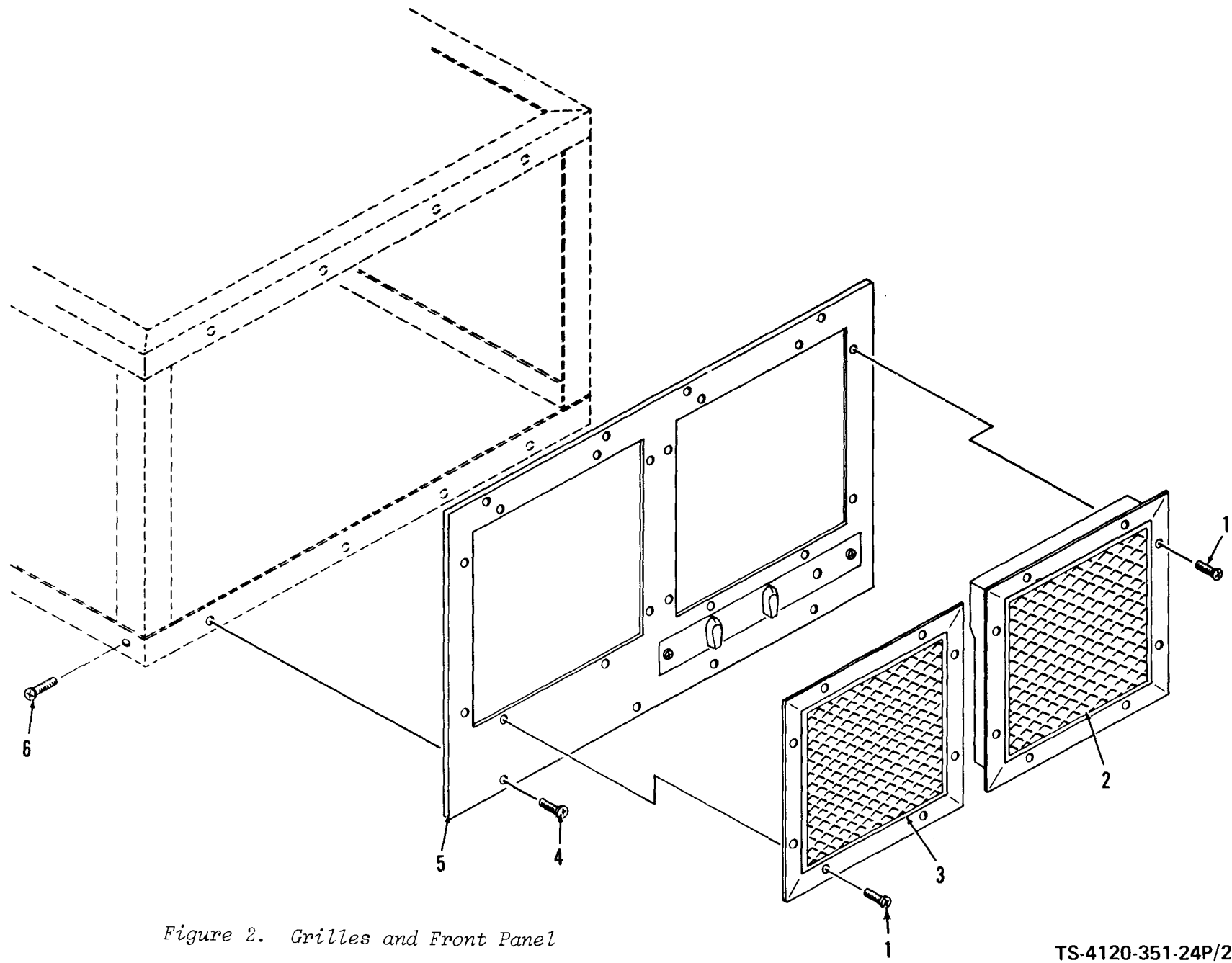

Figure 2. Grilles and Front Panel

TS-4120-351-24P/2

(1) ILLUSTRATION (a) FIG NO.	(2) (b) ITEM NO.	SMR CODE	(3) NATIONAL STOCK NUMBER	(4) PART NUMBER	(5) FSCM	DESCRIPTION	USABLE ON CODE	(7) U\M	(8) QTY INC IN UNIT
2	1	PAOZZ	5305-00-054-6672	MS51957-47	96906	SCREW, MACHINE		EA	35
2	2	PBOZZ		13221E4578	97403	GRILL, RETURN AIR		EA	1
2	3	XBOZZ		13221E4577	97403	GRILL, AIR DIFFUSER		EA	1
2	4	PAOZZ	5305-00-054-6670	MS51957-45	96906	SCREW, MACHINE		EA	1
2	5	XBOZZ		13211E4576	97403	PANEL, FRONT		EA	1
2	6	PAOZZ	5305-00-984-7363	MS35191-272	96906	SCREW, MACHINE		EA	8

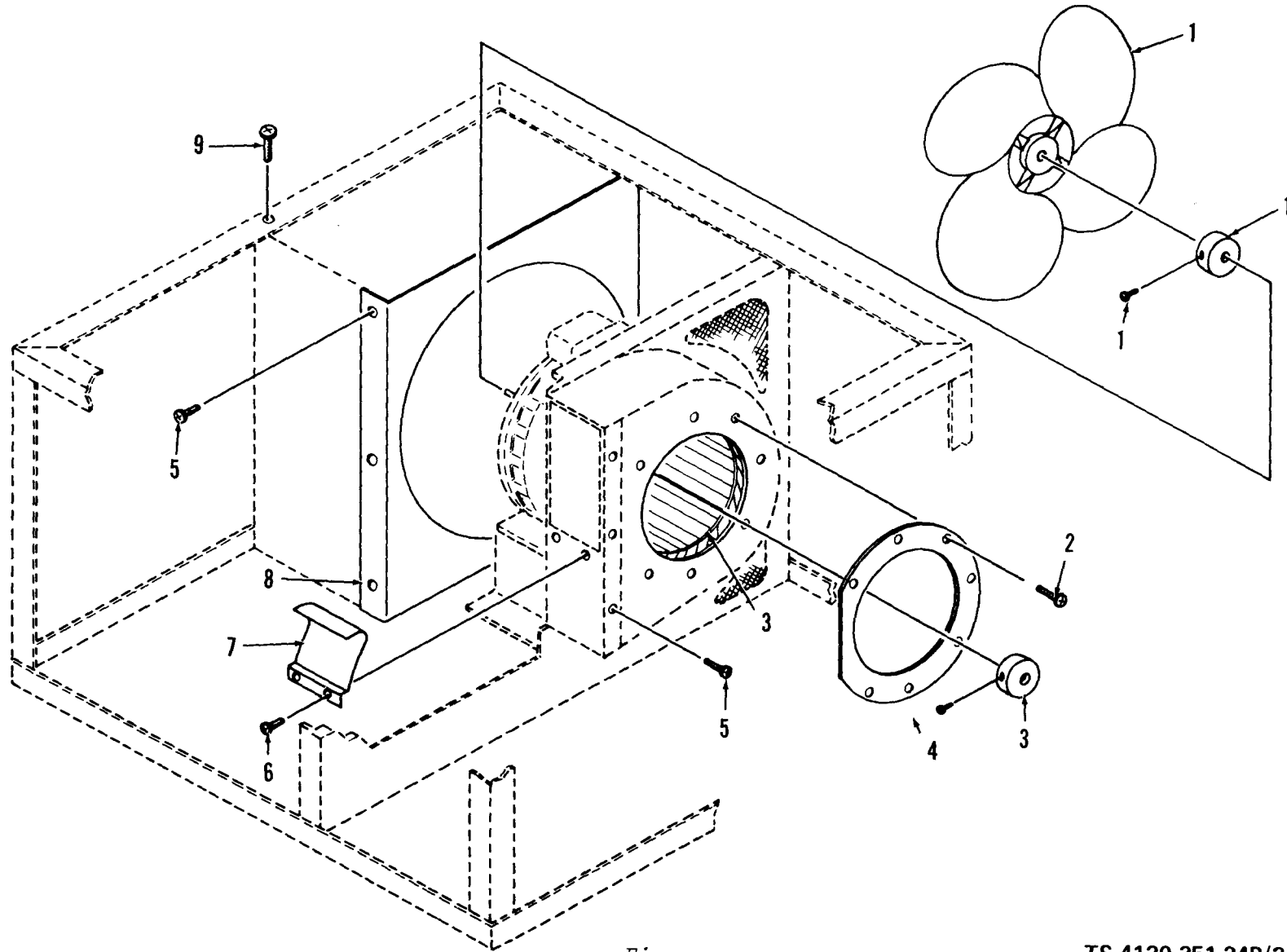
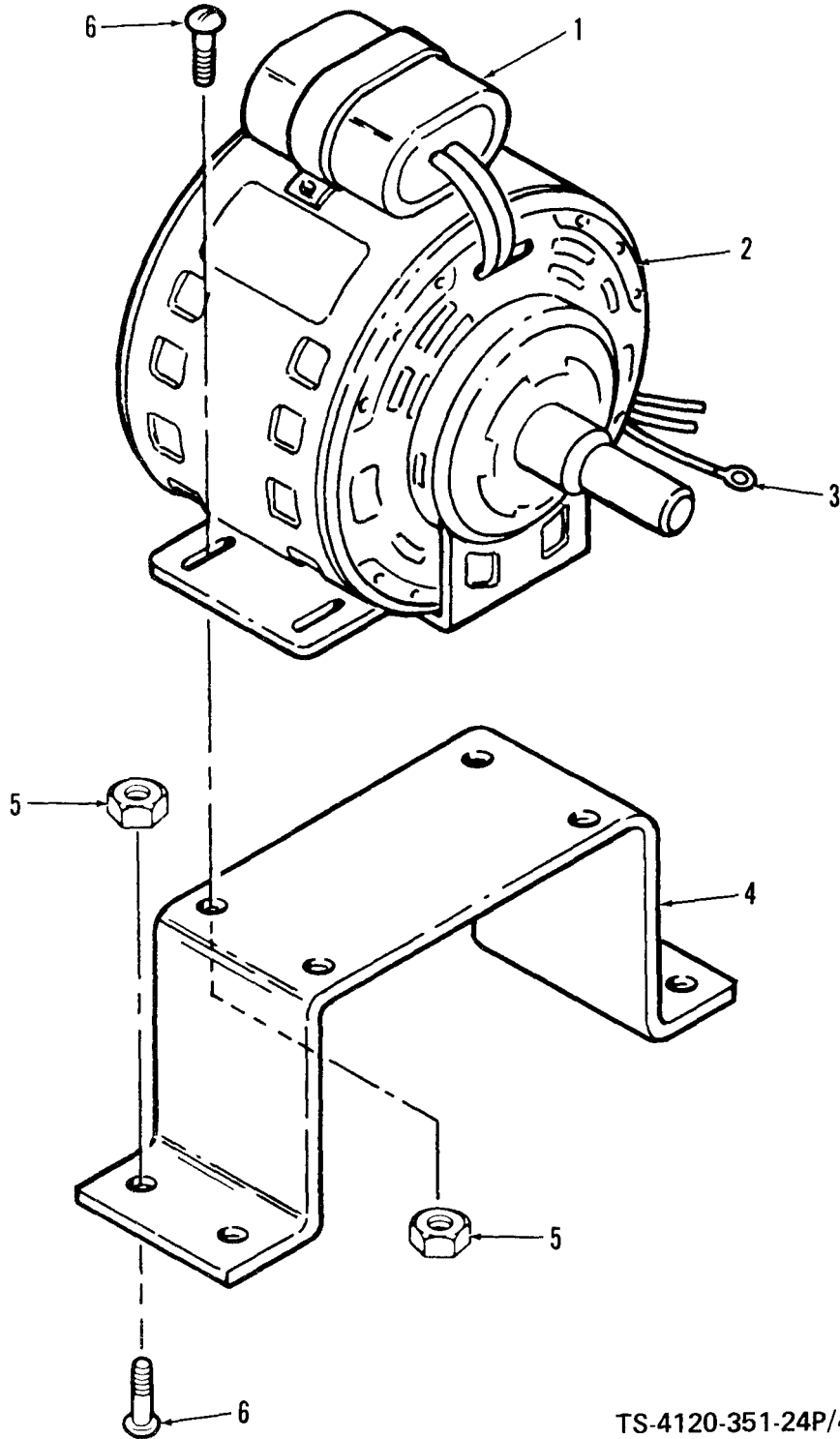

Figure 3. Fans

TS-4120-351-24P/3

(1) ILLUSTRATION (a) FIG NO.	(2) (b) ITEM NO.	SMR CODE	(3) NATIONAL STOCK NUMBER	(4) PART NUMBER	(5) FSCM	TM5-4120-351-24P (6) DESCRIPTION USABLE ON CODE	(7) U\M	(8) QTY INC IN UNIT
						GROUP 02 ELECTRIC MOTOR AND FANS		
3	1	PAOZZ	4140-01-066-9502	13221E4575	97403	IMPELLER, FAN, AXIAL	EA	1
3	2	PAOZZ	5305-00-054-6651	MS51 957-27	96906	SCREW, MACHINE	EA	11
3	3	PAOZZ	4140-01-066-9503	13221E4553	97403	IMPELLER, FAN	EA	1
3	4	XBOZZ		13221E4547	97403	INTAKE RING, BLOWER	EA	1
3	5	PAFZZ	5305-00-054-6669	MS51 957-44	96906	SCREW, MACHINE	EA	18
3	6	PAOZZ	5305-00-054-6653	MS51 957-29	96906	SCREW, MACHINE	EA	2
3	7	XBOZZ		13221E4564	97403	CUTOFF, BLOWER	EA	1
3	8	XBOZZ		13221E4545	97403	SHROUD, CONDENSER	EA	1
3	9	PAOZZ	5305-00-984-7341	MS35191-273	96906	SCREW, MACHINE	EA	3



TS-4120-351-24P/4

Figure 4. Fan Motor

(1) ILLUSTRATION		(2)	(3)	(4)	(5)	(6)	(7)	(8)
(a) FIG NO.	(b) ITEM NO.	SMR CODE	NATIONAL STOCK NUMBER	PART NUMBER	FSCM	DESCRIPTION USABLE ON CODE	U/M	QTY INC IN UNIT
4	1	PAOZZ	5910-01-073-7015	97F5503	01002	RUN CAPACITOR, 3MFD 370 VAC	EA	1
4	2	PAOZZ	6105-01-0725722	13221E4583	97403	MOTOR, ALTERNATING	EA	1
4	3	PAOZZ	5940--0-013-8288	MS25036-107	96906	TERMINAL, LUG	EA	1
4	4	XBOZZ		13221E4539	97403	BRACKET, MOTOR	EA	1
4	5	PAOZZ	5310-00-982-4988	MS21045C4	96906	NUT, SELFLOCKING	EA	8
4	6	PAOZZ	5305-00-267-8973	MS90726-4	96906	SCREW, CAP	EA	8

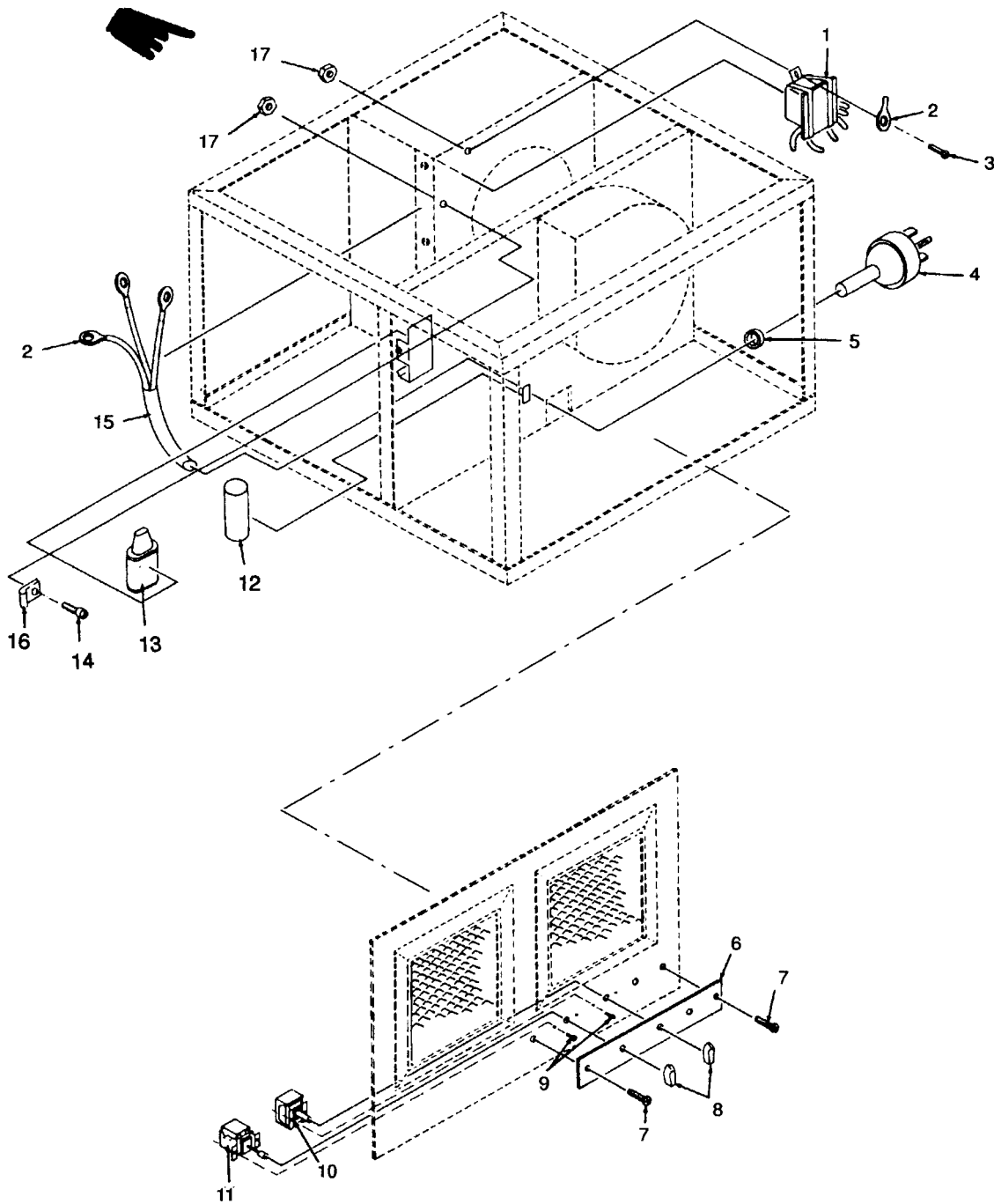
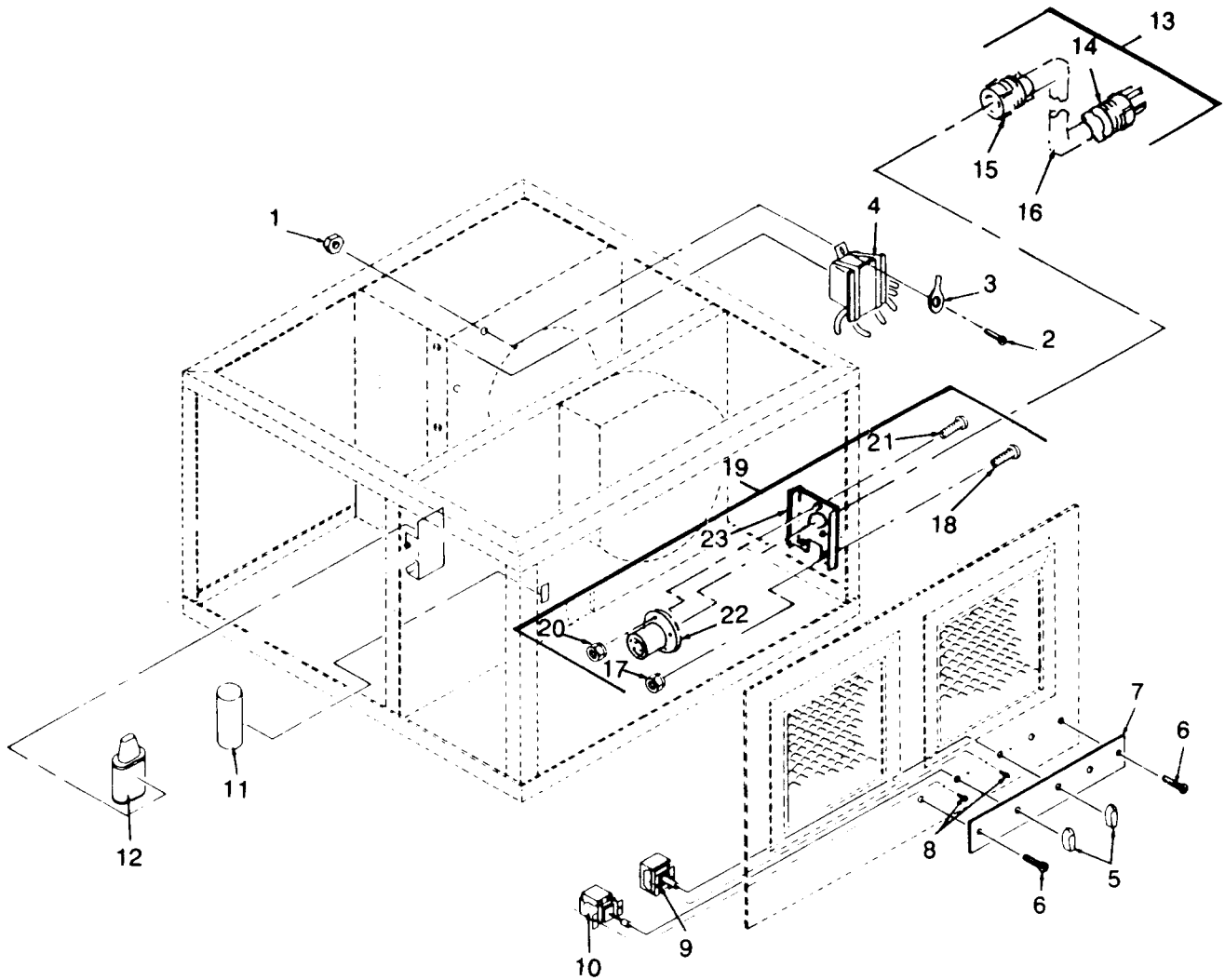

Figure 5. Starting and Protective Devices.

(1) ILLUSTRATION (a) FIG NO.	(2) (b) ITEM NO.	(3) SMR CODE	(4) NATIONAL STOCK NUMBER	(5) PART NUMBER	(6) FSCM	TM5-4120-351-24P DESCRIPTION USABLE ON CODE	(7) U\M	(8) QTY INC IN UNIT
						GROUP 03 STARTING AND PROTECTIVE DEVICES		
5	1	PAOZZ	5945-01-097-1751	3ARR3B2M5	01526	RELAY, VOLTAGE	EA	1
5	2	PAOZZ	5940-00-143-4774	MS25036-153	96906	TERMINAL, LUG	EA	1
5	3	PAOZZ	5305-00-939-0795	MS35218-26	96906	SCREW, MACHINE	EA	1
5	4	PAOZZ	5935-01-023-9777	WC596-13-2	81348	CONNECTOR, PLUG, ELEC	EA	1
5	5	XBOZZ	5975-00-273-0788	SR6P1	28520	BUSHING, STRAIN	EA	1
5	6	XBOZZ	4130-01-204-5065	13221E4567	97403	PLATE, CONTROL PANEL	EA	1
5	7	PAOZZ	5305-00-054-6652	MS51957-28	96906	SCREW, MACHINE	EA	12
5	8	PBOZZ	5355-00-842-3111	MS91528-1A2B	96906	KNOB	EA	3
5	9	PAOZZ	5305-00-958-5474	MS35190-250	96906	SCREW, MACHINE	EA	4
5	10	PAOZZ	5930-00-338-8987	240T6HPC	76854	SWITCH, ROTARY	EA	1
5	11	PAOZZ	5930-00-617-3585	A30-1553	49742	SWITCH, THERMOSTAT	EA	1
5	12	PAOZZ	5910-00-463-3149	ETW460-125	14655	CAPACITOR, FIXED, START	EA	1
5	13	PAOZZ	5910-01-073-5744	97F5457	01002	CAPACITOR, FIXED, RUN	EA	1
5	14	PAOZZ	5305-00-054-6668	MS51957-43	96906	SCREW, MACHINE	EA	1
5	15	PAOZZ	6145-00-112-8671	JC580	81348	CABLE, POWER, ELECTRI	EA	1
5	16	PAOZZ	5310-00-939-0850	MS21083C08	96906	NUT, SELF-LOCKING	EA	REF
5	17	PAOZZ	5310-00-925-9644	MS21083C06	96906	NUT, SELF-LOCKING	EA	2



**Figure 5A. Starting and Protective Devices.
(Depot Overhauled Units Only)**

(1) ILLUSTRATION (a) FIG NO.	(2) (b) ITEM NO.	SMR CODE	CHANGE 2 (3) NATIONAL STOCK NUMBER	(4) PART NUMBER	(5) FSCM	TM5-4120-351-24P (6) DESCRIPTION	USABLE ON CODE	(7) U\M	(8) QTY INC IN UNIT
5A	1	PAOZZ	5310-00-925-9464	MS21083C06	96906	NUT, SELFLOCKING		EA	1
5A	2	PAOZZ	5305-00-939-0795	MS35218-26	96906	SCREW, MACHINE		EA	1
5A	3	PAOZZ	5940-00-143-4774	MS25036-153	96906	TERMINAL LUG		EA	1
5A	4	PAOZZ	5945-01-097-1751	3ARR3B2M5	01526	RELAY, VOLTAGE		EA	1
5A	5	PBOZZ	5355-00-842-3111	MS91528-1A2B	96906	KNOB		EA	3
5A	6	PAOZZ	5305-00-054-6652	MS51957-28	96906	SCREW, MACHINE		EA	12
5A	7	XBOZZ		13221E4567	97403	PLATE, CONTROL PANEL		EA	1
5A	8	PAOZZ	5305-00-958-5474	MS35190-250	96906	SCREW, MACHINE		EA	4
5A	9	PAOZZ	5930-00-338-8987	5-57325-214	76854	SWITCH, SELECTOR		EA	1
5A	10	PAOZZ	5930-01-225-0441	A30-1792	49742	THERMOSTAT		EA	1
5A	11	PAOZZ	5910-00-463-3149	ETW460-125	14655	CAPACITOR, START		EA	1
5A	12	PAOZZ	5910-01-073-5744	97F5457	01002	CAPACITOR, RUN		EA	1
5A	13	PAOOO	4130-01-159-4431	8471-41A	81336	POWER CABLE ASSY		EA	1
5A	14	PAOZZ	5935-01-010-1092	WC596/47-1	81348	.MALE CONNECTOR PLUG		EA	1
5A	15	PAOZZ	5935-01-024-4028	WC596/41-2	81348	.FEMALE CONNECTOR PLUG		EA	1
5A	16	XBOZZ		MIL-C-3432	81349	.WIRE, ELECTRICAL		EA	1
5A	17	PAOZZ	5310-00-926-1835	MS21083C3	96906	NUT, PLAIN, HEX		EA	2
5A	18	PAOZZ	5305-00-059-4568	MS35190-253	96906	SCREW, MACHINE		EA	2
5A	19	XBOOO		8471-29A	81336	RECEPTACLE ASSY		EA	1
5A	20	PAOZZ	5310-00-939-0850	MS21083C08	96906	.NUT, SELF LOCKING		EA	3
5A	21	PAOZZ	5305-00-543-2785	MS35233-45	96906	.SCREW, MACHINE		EA	3
5A	22	PAOZZ	5935-01-170-7454	R678-7327	74545	.RECEPTACLE, MALE		EA	1
5A	23	XBOZZ		8471-29-2	81336	.BRACKET BASE		EA	1

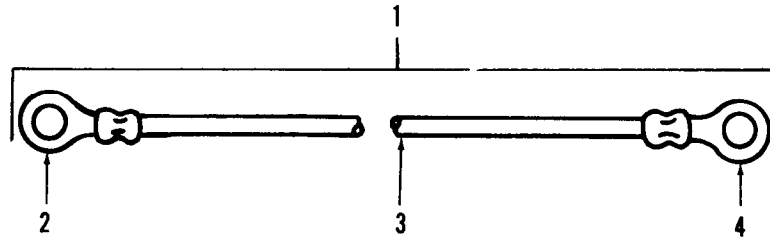

ELECTRICAL LEA PART NUMBER (ITEM #1)	TERMINAL LUG PART NUMBER (ITEM #2)	WIRE MARKING	TERMINAL LUG PART NUMBER (ITEM #3)	WIRE PART NUMBER (ITEM #4)
13221E4585-1	MS25036-156	K1-2 B1-START	61108-1	M5086/1-12-9
13221E4585-2	MS25036-156	K1-5 B1-COMMOI	61108-1	M5086/1-12-9
13221E4585-3	MS25036-156	K1-1 C1	MS25036-111	M5086/1-12-9
13221E4585-4	MS25036-156	K1-4 C1	MS25036-111	M5086/1-12-9
13221E4585-5	MS25036-153	K1-4 S1-L1	MS25036-107	M5086/1-14-9
13221E4585-6	MS25036-153	S1-2 S2-1	MS25036-107	M5086/1-14-9

Figure 6. Wiring

TS-4120-351-24P/6

(1) ILLUSTRATION (a) FIG NO.		(2) (b) ITEM NO.		(3) SMR CODE	(4) NATIONAL STOCK NUMBER	(5) PART NUMBER	(6) DESCRIPTION	(7) USABLE ON CODE	(8) QTY INC IN UNIT
TM5-4120-351-24P									
GROUP 04 WIRING									
6	1	XBOZZ			13221E4585-1	97403	LEAD, ELECTRICAL	EA	1
6	2	PAOZZ	5940-00-143-4775		MS25036-156	96906	TERMINAL, LUG	EA	1
6	3	PAOZZ	5999-01-074-2271		61108-1	00779	TERMINAL, LUG	EA	1
6	4	PAOZZ	6145-00-578-7521		M5086/1-12-9	81349	WIRE, ELECTRIC	FT	1
6	1	XBOZZ			13221E4585-2	97403	LEAD, ELECTRICAL	EA	1
6	2	PAOZZ	5940-00-143-4775		MS25036-156	96906	TERMINAL, LUG	EA	1
6	3	PAOZZ	5999-01-074-2271		61108-1	00779	TERMINAL, LUG	EA	1
6	4	PAOZZ	6145-00-578-7521		M5086/1-12-9	81349	WIRE, ELECTRIC	FT	1
6	1	XBOZZ			13221E4585-3	97403	LEAD, ELECTRICAL	EA	1
6	2	PAOZZ	5940-00-143-4775		MS25036-156	96906	TERMINAL, LUG	EA	1
6	3	PAOZZ	5940-00-204-8990		MS25036-111	96906	TERMINAL, LUG	EA	1
6	4	PAOZZ	6145-00-578-7521		M5086/1-12-9	81349	WIRE, ELECTRIC	FT	1
6	1	XBOZZ			13221E4585-4	97403	LEAD, ELECTRICAL	EA	1
6	2	PAOZZ	5940-00-143-4775		MS25036-156	96906	TERMINAL, LUG	EA	1
6	3	PAOZZ	5940-00-204-8990		MS25036-111	96906	TERMINAL, LUG	EA	1
6	4	PAOZZ	6145-00-578-7521		M5C86/1-12-9	81349	WIRE, ELECTRIC	FT	1
6	1	XBOZZ			13221E4585-5	97403	LEAD, ELECTRICAL	EA	1
6	2	PAOZZ	5940-00-143-4774		MS25036-153	96906	TERMINAL, LUG	EA	1
6	3	PAOZZ	5305-00-054-6670		MS51957-45	96906	SCREW, MACHINE?????	EA	1
6	4	PAOZZ	6145-00-578-7516		M5086/1-14-9	81349	WIRE, ELECTRIC	FT	1
6	1	XBOZZ			13221E4585-6	97403	LEAD, ELECTRIC	EA	1
6	2	PAOZZ	5940-00-143-4774		MS25036-153	96906	TERMINAL, LUG	EA	1
6	3	PAOZZ	5940-01-013-8288		MS25036-107	96906	TERMINAL, LUG	EA	1
6	4	PAOZZ	6145-00-578-7516		M5C86/1-14-9	81349	WIRE, ELECTRIC	FT	1

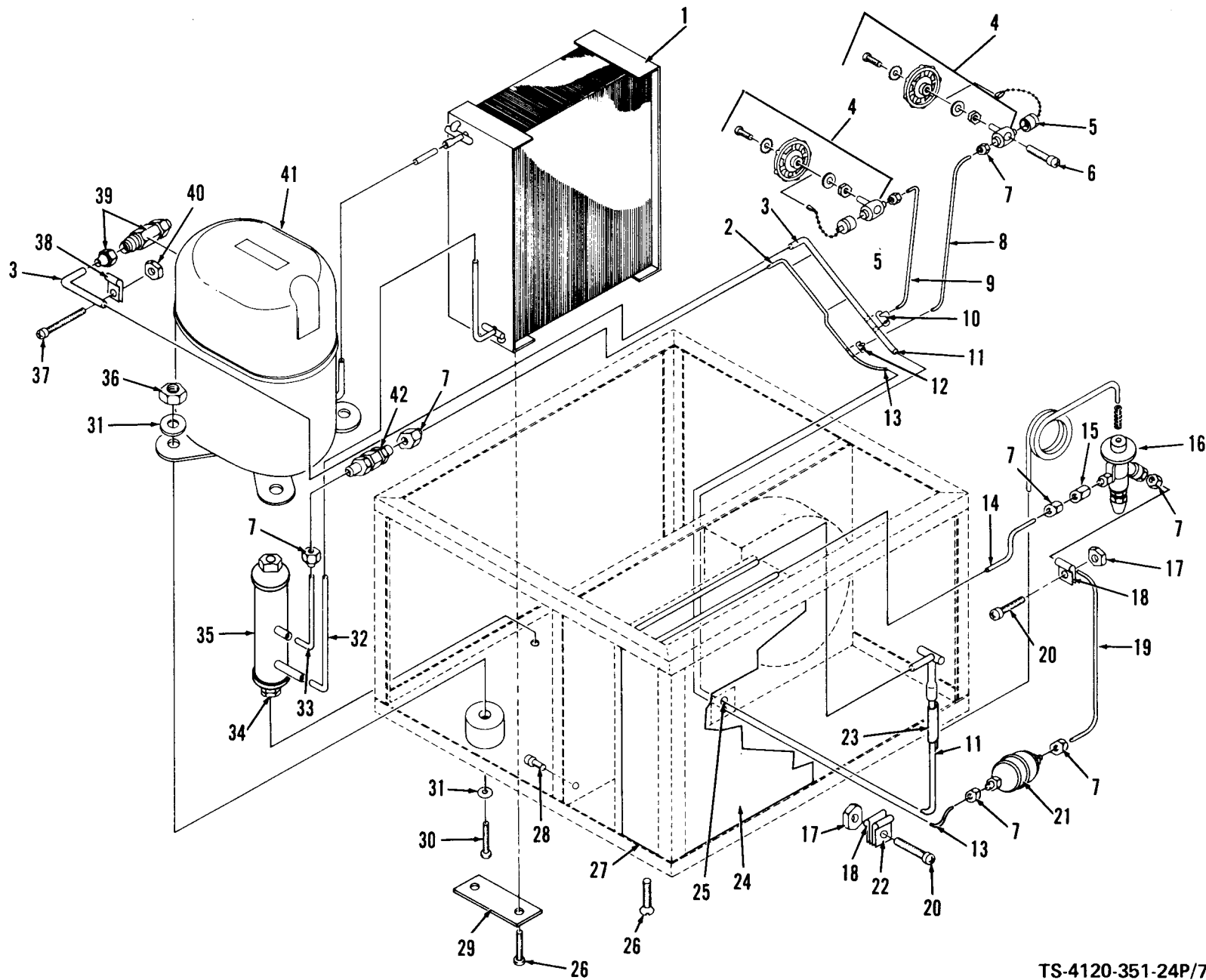

Figure 7. Gas Compressor, Piping and

TS-4120-351-24P/7

(1) ILLUSTRATION (a) FIG NO.	(2) (b) ITEM NO.	(3) SMR CODE	(4) NATIONAL STOCK NUMBER	(5) PART NUMBER	(6) TM5-4120-351-24P DESCRIPTION FSCM	(7) USABLE ON CODE U\M	(8) QTY INC IN UNIT
GROUP 05 GAS COMPRESSOR, PIPING AND COMPONENTS							
7	1	PAFZZ		13221E4535	97403 COIL, EVAPORATOR	EA	1
7	2	PBFZZ	4710-00-203-3173	WWT775-1- 20DXR03 2WALL	81348 TUBE,COPPER	EA	1
7	3	PAFZZ	4710-00-203-3171	WWT775-1- 40DXR03 0WALL	81348 TUBE,COPPER	FT	7
7	4	XBFZZ	4820-01-015-6690	V2S4	07295 VALVE, SERVICE	EA	2
7	5	XBOZZ		4620-4AC	07295 CAP AND CHAIN	EA	2
7	6	PAOZZ	5305-00-054-6651	MS51957-27	96906 SCREW, MACHINE	EA	1
7	7	PBFZZ	4730-00-189-2737	MS35872-2	96906 NUT, FLARE	EA	6
7	8	PBFZZ	4710-00-203-3173	WWT775-1- 20DXR03 2WALL	81348 TUBE, COPPER	EA	1
7	9	PBFZZ	4710-00-203-3173	WWT775-1- 20DXR03 2WALL	81348 TUBE, COPPER	EA	1
7	10	PBFZZ	4730-00-821-9184	W40350	41947 TEE	EA	1
7	11	PAFZZ	4710-00-203-3171	WWT775-1- 40DXR03 0WALL	81348 TUBE, COPPER	FT	1
7	12	PBFZZ	4730-00-257-2163	MS35929-2	96906 TEE	EA	2
7	13	PAFZZ	4710-00-203-3171	WWT775-1- 40DXR03 0WALL	81348 TUBE, COPPER	FT	1
7	14	PAFZZ	4710-00-203-3171	WWT775-1- 40DXR03	81348 TUBE, COPPER	FT	1
7	15	XBFZZ		SAE-J516	81348 ADAPTER,REDUCER	EA	1
7	16	PAOZZ	4820-00-472-2641	207CFB14-70207- 138	91494 VALVE,EXPANSION	EA	1
7	17	PAOZZ	5310-00-939-0850	MS2108C008	96906 NUT, SELF LOCKING	EA	1
7	18	PAOZZ	5340-00-205-6301	MS219190G4	96906 CLAMP,LOOP	EA	2
7	19	PAFZZ	4710-00-203-3171	WWT775-1- 40DXR03 0WALL	81348 TUBE, COPPER	FT	1
7	20	PAOZZ	5305-00-054-6668	MS51957-43	96906 SCREW, MACHINE	EA	1
7	21	PAFZZ	4130-00-081-5399	ADK052	70255 DEHYDRATOR, DESICCAN	EA	1
7	22	PAOZZ	5340-00-106-0550	MS21104DB	96906 CLAMP, LOOP	EA	1
7	23	XBOZZ		N0165	77464 TAPE, INSULATION	FT	V
7	24	PAFZZ		13221E4534	97403 COIL, CONDENSER	EA	1
7	25	PAOZZ	5325-00-960-2410	MS21266-1N	96906 GROMMET, PLASTIC	EA	1
7	26	PAOZZ	5305-00-984-7351	MS35191-275	96906 SCREW, MACHINE	EA	1
7	27	XBOZZ		13221E4542	97403 SPACER, EVAPORATOR	EA	2
7	28	PAOZZ	5305-00-054-6669	MS51957-44	96906 SCREW, MACHINE	EA	1
7	29	XBOZZ		13221E4543	97403 SPACER, CONDENSER	EA	2
7	30	PAOZZ	5305-00-269-2809	MS90726-66	96906 SCREW, CAP	EA	4
7	31	PAOZZ	5310-00-080-6004	MS27183-14	96906 WASHER, FLAT	EA	8
7	32	PAFZZ	4710-00-203-3173	WWT775-1- 20DXR03 2WALL	81348 TUBE, COPPER	EA	1
7	33	PAFZZ	4710-00-203-3173	WWT775-1- 20DXR03 2WALL	81348 TUBE,COPPER	EA	1
7	34	PAOZZ	5310-00-241-6640	MS16228-6C	96906 NUT, SELF LOCKING	EA	1
7	35	XBFZZ		23894	78657 RECEIVER, LIQUID	EA	1

(1) ILLUSTRATION		(2)		(3)	(4)	(5)	TM5-4120-351-24P (6)	(7)	(8)
(a) FIG NO.	(b) ITEM NO.	SMR CODE	NATIONAL STOCK NUMBER	PART NUMBER	FSCM	DESCRIPTION	USABLE ON CODE	U\M	QTY INC IN UNIT
7	36	PAOZZ	5310-00-059-9264	MS21045C6	96906	NUT, SELFLOCKING		EA	4
7	37	PAOZZ	5305-00-984-7341	MS35191-273	96906	SCREW, MACHINE		EA	1
7	38	PAOZZ	5340-01-024-6617	MS21919D12	96906	CLAMP, LOOP		EA	1
7	39	PAFZZ	4730-00-289-0365	SAE-J513	81349	NUT, FLARE, REDUCING		EA	1
7	40	PAOZZ	5310-00-926-1835	MS21083C3	96906	NUT, SELFLOCKING		EA	1
7	41	PAFZZ	4130-01-174-4064	13225E8600	97403	COMPRESSOR		EA	1
7	42	PBFZZ	6685-00-758-5244	A15966	41947	INDICATOR		EA	1

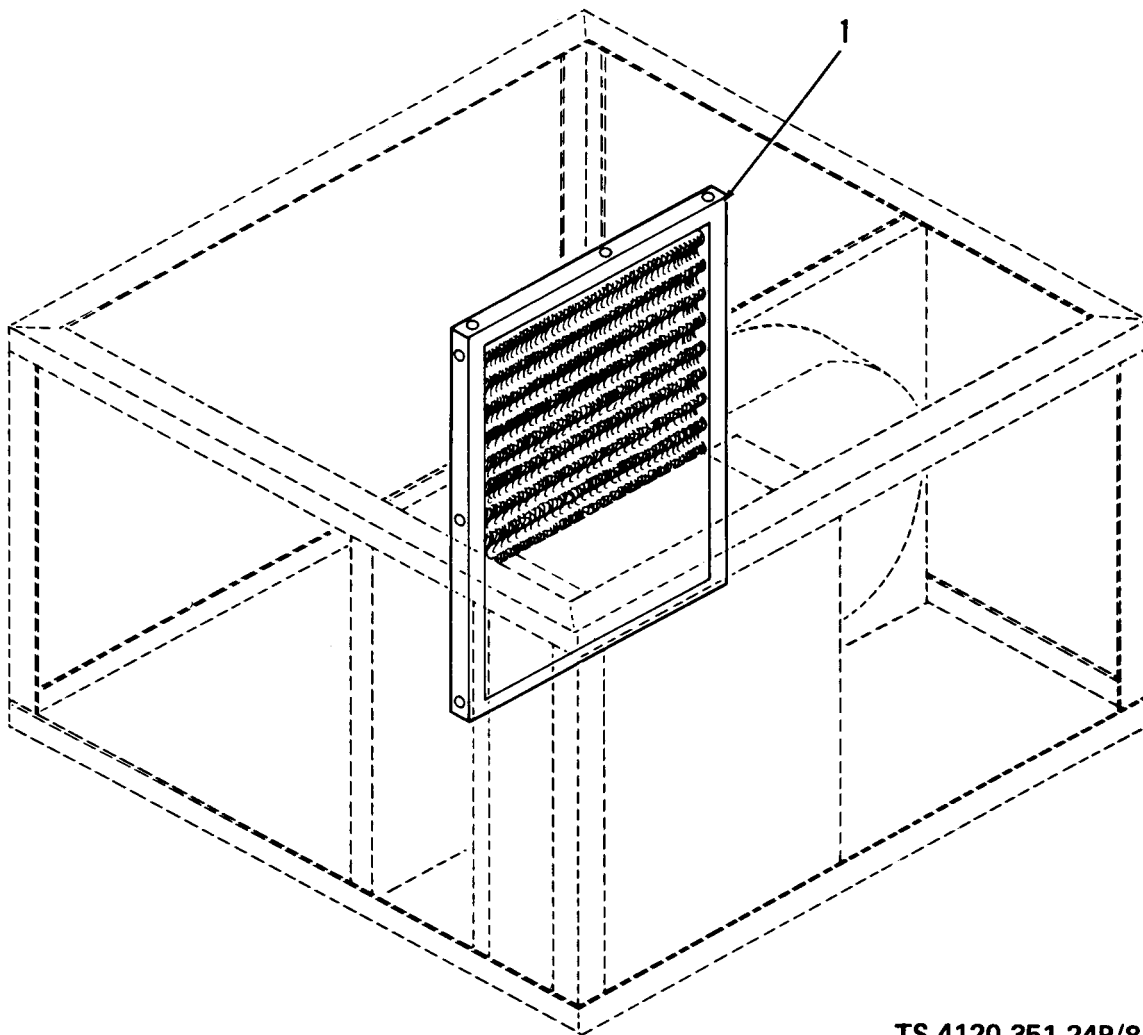

Figure 8. Filter

TS-4120-351-24P/8

(1) ILLUSTRATION (a) FIG NO.	(2) (b) ITEM NO.	SMR CODE	(3) NATIONAL STOCK NUMBER	(4) PART NUMBER	(5) FSCM	TM5-4120-351-24P (6) DESCRIPTION USABLE ON CODE	(7) U\M	(8) QTY INC IN UNIT
8	1	PAOZZ	4130-01-071-5466	13221E4533	97403	GROUP 06 - FILTER FILTER, AIR	EA	1

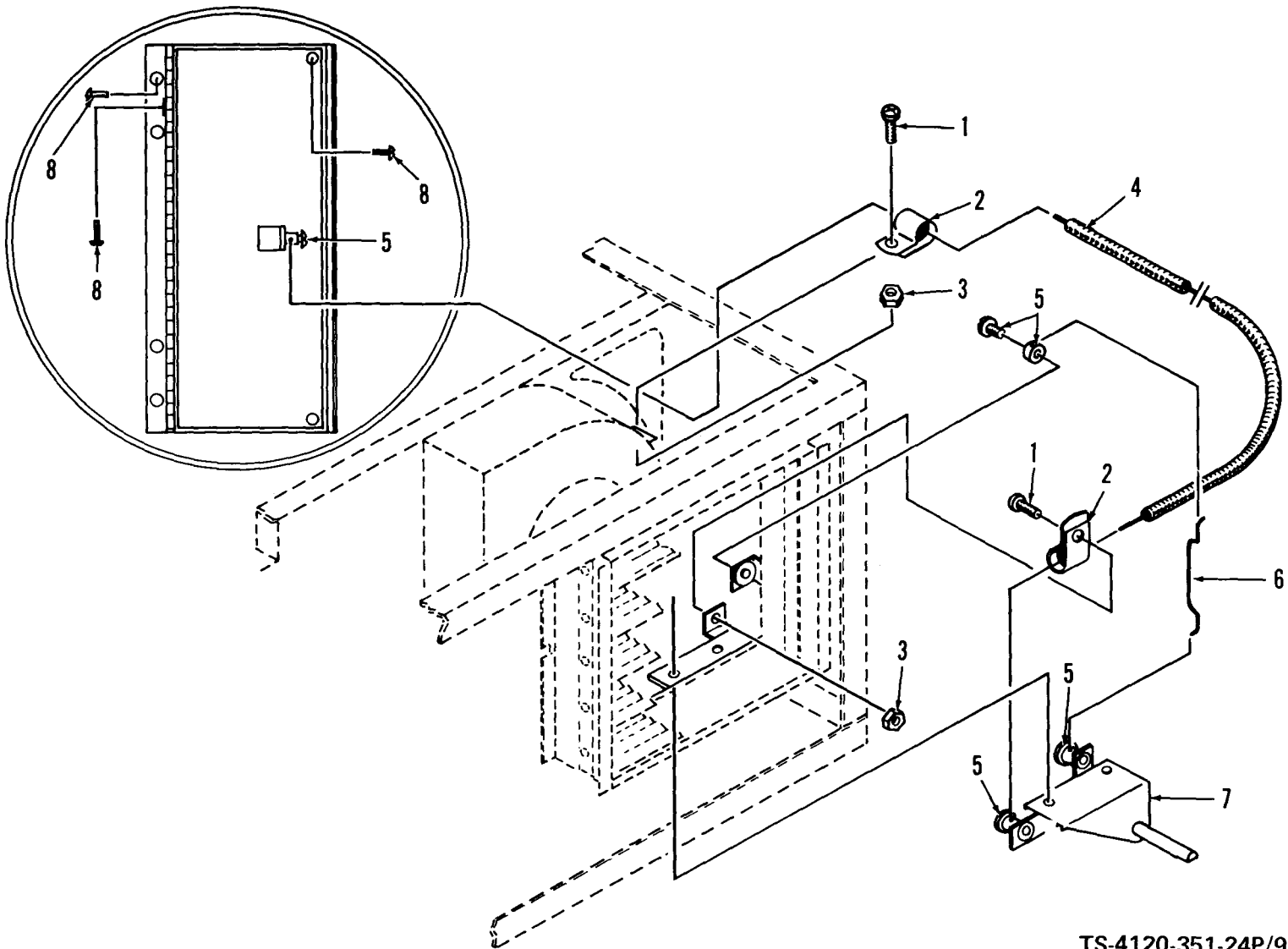

Figure 9. Actuator

TS-4120-351-24P/9

(1) ILLUSTRATION (a) FIG NO.	(2) (b) ITEM NO.	SMR CODE	(3) NATIONAL STOCK NUMBER	(4) PART NUMBER	(5) FSCM	TM5-4120-351-24P (6) DESCRIPTION	USABLE ON CODE	(7) U\M	(8) QTY INC IN UNIT
						GROUP 07 ACTUATOR			
9	1	PAOZZ	5305-00-054-6668	MS51957-43	96906	SCREW, MACHINE		EA	1
9	2	PAOZZ	5340-00-600-7386	MS21104WD3	96906	CLAMP, LOOP		EA	1
9	3	PAOZZ	5310-00-939-0850	MS21083C08	96906	NUT, SELFLOCKING		EA	1
9	4	XBOZZ		13216E6108-5	97403	CONTROL ASSEMBLY		EA	1
9	5	XBOZZ	5340-00-923-8544	FT191	70436	POST, MECHANICAL		EA	4
9	6	XBOZZ		QQ-W-423	81349	WIRE, STEEL		EA	1
9	7	XBOZZ		13221E4570	97403	VENT LINKAGE		EA	1
9	8	PAOZZ	5305-00-054-6652	MS51957-28	96906	SCREW, MACHINE		EA	1

NATIONAL STOCK NUMBER AND PART NUMBER INDEX

STOCK NUMBER	FIGURE NO.	ITEM NO.	STOCK NUMBER	FIGURE NO.	ITEM NO.
5305-00-054-6651	3	2	6145-00-578-7516	6	4
5305-00-054-6651	7	6	6145-00-578-7521	6	4
5305-00-054-6652	5	7	6145-00-578-7521	6	4
5305-00-054-6652	5A	6	6145-00-578-7521	6	4
5305-00-054-6653	9	8	6145-00-578-7521	6	4
5305-00-054-6653	3	9	5340-00-600-7386	9	2
5305-00-054-6668	5	12	5930-00-617-3585	5	11
5305-00-054-6668	5	12	6685-00-758-5244	7	42
5305-00-054-6668	7	20	4730-00-821-9184		
5305-00-054-6669	9	1	5355-00-842-3111	3	5
5305-00-054-6669	3	5	5355-00-842-3111	5A	5
5305-00-054-6669	7	28	5340-00-923-8544	9	5
5305-00-054-6670	1	2	5310-00-925-9646	5	17
5305-00-054-6670	2	4	5310-00-925-9646	5A	1
5305-00-054-6671	1	10	5310-00-926-1835	7	40
5305-00-054-6672	1	5	5310-00-926-1835	5A	17
5305-00-054-6672	2	1	5305-00-939-0795	5	3
5310-00-059-9264	7	36	5305-00-939-0795	5A	2
5310-00-059-4568	5A	18	5310-00-939-0850	5	16
5310-00-080-6004	7	31	5310-00-939-0850	20	20
4130-00-081-5399	7	21	5310-00-939-0850	7	17
5340-00-106-0550	7	22	5310-00-939-0850	9	3
5940-00-143-4774	5	2	5320-00-957-2499	1	7
5940-00-143-4774	5A	3	5305-00-958-5474	5	9
5940-00-143-4774	6	2	5305-00-958-5474	5A	8
5940-00-143-4774	6	2	5325-00-960-2410	7	25
5940-00-143-4775	6	2	5310-00-982-4988	4	5
5940-00-143-4775	6	2	5305-00-984-7341	3	9
5940-00-143-4775	6	2	5305-00-984-7341	7	37
5940-00-143-4775	6	2	5305-00-984-7351	7	26
4730-00-189-2737			5305-00-984-7363	2	6
4710-00-203-3171			6145-00-997-7051	5	15
4710-00-203-3171			5935-01-010-1092	5A	14
4710-00-203-3171	7	3	5940-01-013-8288	4	3
4710-00-203-3171	7	19	5940-01-013-8288	6	3
4710-00-203-3173			4820-01-015-6690	7	4
4710-00-203-3173			5935-01-023-9777	5	4
4710-00-302-3173	7	2	5935-01-024-4028	5A	17
4710-00-203-3173	7	32	5340-01-024-6617	7	38
4710-00-203-3173	7	33	4140-01-066-9502	3	1
5940-00-204-8990	6	3	4140-01-066-9503	3	3
5940-00-204-8990	6	3	4130-01-071-5466		
5340-00-205-6301	7	18	6105-01-072-5722	4	2
5310-00-241-6640	7	34	5910-01-073-5744	5A	12
4730-00-257-2163			5910-01-073-5744	5	13
5305-00-267-8973	4	6	5999-01-074-2271	6	3
5305-00-269-2809	7	30	5999-01-074-2271	6	3
5975-00-273-0788	5	5	5945-01-097-1751	5A	4
4730-00-289-0365	7	39	5945-01-097-1751	5	1
5930-00-338-8987	5	10	4130-01-159-4431	5A	13
5930-00-338-8957	5A	9	5935-01-179-7454	5A	22
5910-00-463-3149	5	14	4130-01-174-4064	7	41
5910-00-463-3149	5A	11	4120-01-188-8199	1	12
4820-00-472-2641	7	16	4130-01-204-5065	5	6
5305-00-543-2785	5A	21	5930-01-225-0441	5A	10
6145-00-578-7516	6	4			

PART NUMBER	FIG. NO.	ITEM NO.	ITEM NO.	PART NUMBER	FSCM	FIG. NO.	ITEM NO.
			21	JC580	81348		
ADK052	70255	7	42	MIL-C-3432	81349	5	15
A15966	41947	7	10	MS16228-6C	96906	5A	16
A30-1792	49742	5A	11	MS20604B4W2	96906	7	34
A30-1553	49742	5	13	MS21045C4	96906	1	7
ETW460-125	9025	5	11	MS21045C6	96906	4	5
ETW460-125	14655	5A	5	MS2108CC06	96906	7	36
FT191	70436	9	15	MS21083C06	96906	5	17
FO-034GR(3/14)0565	81344	3				5A	1

NATIONAL STOCK NUMBER AND PART NUMBER INDEX

PART NUMBER	FSCM	FIG. NO.	ITEM NO.	PART NUMBER	FSCM	FIG. NO.	ITEM NO.
MS21083C06	96906	5	15	SAE-J513	81343	7	39
MS21083C08	96906	5A	20	SAE-J516	81343	7	15
MS21083C08	96906	7	7	SR6P1	28520	5	5
MS21083C08	96906	9	3	V254	07295	7	4
MS21083C3	96906	7	40	WC596/13-2	81348	5	4
MS21083C3	96906	5A	17	WC596/41-2	81348	5A	15
MS21104D8	96906	7	22	WC596/47-1	81348	5A	14
MS21104W03	96906	9	2	WWT775-1-20DXR032WALL	81348		
MS21266-1N	96906	7	25	WWT775-1-20DXR032WALL	81348		
MS21919D04	96906	7	18	WWT775-1-20DXR032WALL	81348	7	2
MS21919D12	96906	7	38	WWT775-1-20DXR032WALL	81348	7	32
MS25036-107	96906	4	3	WWT775-1-20DXR032WALL	81348	7	33
MS25036-153	96906	5A	3	WWT775-1-40DXR030WALL	81348	7	3
MS25036-107	96906	6	3	WWT775-1-40DXR030WALL	81348		
MS25036-111	96906	6	3	WWT775-1-40DXR030WALL	81348		
MS25036-111	96906	6	3	WWT775-1-40DXR030WALL	81348	7	19
MS25036-153	96906	6	2	W40350	41947		
MS25036-153	96906	6	2	13216E6108-5	97403	9	4
MS25036-153	96906	6	2	13221E4530	97403	1	4
MS25036-156	96906	6	2	13221E4531	97403	1	3
MS25036-156	96906	6	2	13221E4532	97403	1	1
MS25036-156	96906	6	2	13221E4533	97403		
MS25036-156	96906	6	2	13221E4534	97403	7	24
MS27183-14	96906	7	31	13221E4535	97403	7	1
MS35190-250	96906	5	9	13221E4536	97403	1	9
MS35190-250	96906	5A	8	13221E4537	97403	1	8
MS35190-253	96906	5A	18	13221E4539	97403	4	4
MS35191-272	96906	2	6	13221E4542	97403	7	27
MS35191-273	96906	3	9	13221E4543	97403	7	29
MS35191-273	96906	7	37	13221E4547	97403	3	4
MS35191-275	96906	7	26	13221E4553	97403	3	3
MS35218-26	96906	5	3	13221E4562	97403	1	6
MS35218-26	96906	5A	2	13221E4563	97403	1	11
MS35233-45	96906	5A	21	13221E4564	97304	3	7
MS35872-2	96906			13221E4567	97403	5	6
MS35929-2	96906			13221E4552	97403	1A	2
MS51957-27	96906	3	2	13221E4567	97403	5A	7
MS51957-27	96906	7	6	13221E4584	97403	1A	3
MS51957-28	96906	5	7	13221E4569	97403	1	12
MS51957-28	96906	5A	6	13221E4570	97403	9	7
MS51957-28	96906	9	8	13221E4575	97403	3	1
MS51957-29	96906	3	6	13221E4576	97403	2	5
MS51957-43	96906	5	12	13221E4577	97403	2	3
MS51957-43	96906	7	20	13221E4578	97403	2	2
MS51957-43	96906	9	1	13221E4583	97403	4	2
MS51957-44	96906	3	5	13221E4585-1	97403	6	1
MS51957-44	96906	7	28	13221E4585-2	97403	6	1
MS51957-45	96906	1	2	13221E4585-3	97403	6	1
MS51957-45	96906	2	4	13221E4585-4	97403	6	1
MS51957-46	96906	1	10	13221E4585-5	97403	6	1
MS51957-47	96906	1	5	13221E4585-6	97403	6	1
MS51957-47	96906	2	1	13225E8600	97403	7	41
MS90725-4	96906	4	6	207CF814-70207-138	91494	7	16
MS90726-66	96906	7	30	23894	78857	7	35
MS91528-1A2B	96906	3	5	240T6HPC	76854	5	10
MS91528-1A2B	96906	5A	5	3ARR3B2M5	24446	5	1
M5086/1-12-9	81349	6	4	3ARR3B2M5	01526	5A	4
M5086/1-12-9	81349	6	4	4620-4AC	07295	7	5
M5086/1-12-9	81349	6	4	5-57325-214	76854	5A	9
M5086/1-12-9	81349	6	4	61108-1	00779	6	3
M5086/1-14-9	81349	6	4	61108-1	00779	6	3
M5086/1-14-9	81349	6	4	8471-29A	81336	5A	19
N0165	77464	7	2	8471-292	81336	5A	23
QQ-W-423	81349	9	6	8471-41A	81336	5A	13
R612-77-63045	97450	1A	1	97F5457	01002	5	13
4678-73-27	74545	5A	22				

By Order of the Secretary of the Army:

Official:

J. C. PENNINGTON
Major General, United States Army
The Adjutant General

E. C. MEYER
General, United States Army
Chief of Staff

DISTRIBUTION:

To be distributed in accordance with DA Form 12-25C, Organizational Maintenance requirements for Environmental Equipment, Air Conditioners, 9,000 BTU

These are the instructions for sending an electronic 2028

The following format must be used if submitting an electronic 2028. The subject line must be exactly the same and all fields must be included; however only the following fields are mandatory: 1, 3, 4, 5, 6, 7, 8, 9, 10, 13, 15, 16, 17, and 27.

From: "Whomever" <whomever@avma27.army.mil>
To: mpmt%avma28@st-louis-emh7.army.mil
Subject: DA Form 2028

1. **From:** Joe Smith
2. **Unit:** home
3. **Address:**4300 Park
4. **City:** Hometown
5. **St:** MO
6. **Zip:** 77777
7. **Date Sent:** 19-OCT-93
8. **Pub no:** 55-2840-229-23
9. **Pub Title:** TM
10. Publication Date: 04-JUL-85
11. **Change Number:** 7
12. Submitter Rank: MSG
13. **Submitter FName:** Joe
14. **Submitter MName:** T
15. **Submitter LName:** Smith
16. **Submitter Phone:** 123-123-1234
17. **Problem:** 1
18. **Page:** 2
19. **Paragraph:** 3
20. **Line:** 4
21. **NSN:** 5
22. **Reference:** 6
23. **Figure:** 7
24. **Table:** 8
25. **Item:** 9
26. **Total:** 123
27. **Text:**

This is the text for the problem below line 27.

THE METRIC SYSTEM AND EQUIVALENTS

WEIGHT MEASURE

1 Centimeter = 10 Millimeters = 0.01 Meters = 0.3937 Inches
 1 Meter = 100 Centimeters = 1000 Millimeters = 39.37 Inches
 1 Kilometer = 1000 Meters = 0.621 Miles

WEIGHTS

1 Gram = 0.001 Kilograms = 1000 Milligrams = 0.035 Ounces
 1 Kilogram = 1000 Grams = 2.2 lb.
 1 Metric Ton = 1000 Kilograms = 1 Megagram = 1.1 Short Tons

LIQUID MEASURE

1 Milliliter = 0.001 Liters = 0.0338 Fluid Ounces
 1 Liter = 1000 Milliliters = 33.82 Fluid Ounces

SQUARE MEASURE

1 Sq. Centimeter = 100 Sq. Millimeters = 0.155 Sq. Inches
 1 Sq. Meter = 10,000 Sq. Centimeters = 10.76 Sq. Feet
 1 Sq. Kilometer = 1,000,000 Sq. Meters = 0.386 Sq. Miles

CUBIC MEASURE

1 Cu. Centimeter = 1000 Cu. Millimeters = 0.06 Cu. Inches
 1 Cu. Meter = 1,000,000 Cu. Centimeters = 35.31 Cu. Feet

TEMPERATURE

$5/9(^{\circ}\text{F} - 32) = ^{\circ}\text{C}$
 212° Fahrenheit is equivalent to 100° Celsius
 90° Fahrenheit is equivalent to 32.2° Celsius
 32° Fahrenheit is equivalent to 0° Celsius
 $9/5^{\circ}\text{C} + 32 = ^{\circ}\text{F}$

APPROXIMATE CONVERSION FACTORS

TO CHANGE	TO	MULTIPLY BY
Inches	Centimeters	2.540
Feet	Meters	0.305
Yards	Meters	0.914
Miles	Kilometers	1.609
Square Inches	Square Centimeters	6.451
Square Feet	Square Meters	0.093
Square Yards	Square Meters	0.836
Square Miles	Square Kilometers	2.590
Acres	Square Hectometers	0.405
Cubic Feet	Cubic Meters	0.028
Cubic Yards	Cubic Meters	0.765
Fluid Ounces	Milliliters	29.573
its	Liters	0.473
arts	Liters	0.946
allons	Liters	3.785
Ounces	Grams	28.349
Pounds	Kilograms	0.454
Short Tons	Metric Tons	0.907
Pound-Feet	Newton-Meters	1.356
Pounds per Square Inch	Kilopascals	6.895
Miles per Gallon	Kilometers per Liter	0.425
Miles per Hour	Kilometers per Hour	1.609

TO CHANGE	TO	MULTIPLY BY
Centimeters	Inches	0.394
Meters	Feet	3.280
Meters	Yards	1.094
Kilometers	Miles	0.621
Square Centimeters	Square Inches	0.155
Square Meters	Square Feet	10.764
Square Meters	Square Yards	1.196
Square Kilometers	Square Miles	0.386
Square Hectometers	Acres	2.471
Cubic Meters	Cubic Feet	35.315
Cubic Meters	Cubic Yards	1.308
Milliliters	Fluid Ounces	0.034
Liters	Pints	2.113
Liters	Quarts	1.057
ers	Gallons	0.264
ms	Ounces	0.035
ograms	Pounds	2.205
Metric Tons	Short Tons	1.102
Newton-Meters	Pounds-Feet	0.738
Kilopascals	Pounds per Square Inch	0.145
ometers per Liter	Miles per Gallon	2.354
ometers per Hour	Miles per Hour	0.621

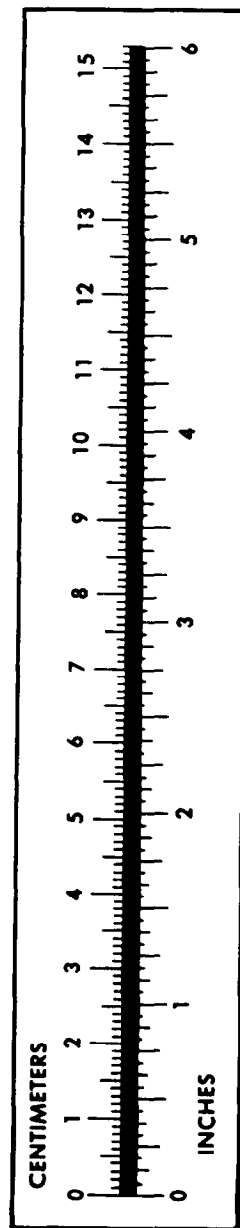

PIN: 043787-004